

AUTO CASCADE

SAFE AND AUTOMATIC CASCADE SCBA FILLING

The world leader in high pressure breathing air is proud to offer the premier method of automatically cascading your air storage system. The system utilizes our patent pending manifold block with integral valve bodies. Couple this with a commercially available PLC controller and you have the simplest cascade system available in the marketplace today.

- › **FOUR TO ONE SAFETY FACTOR:**
All components are manufactured for 6000 PSIG service
- › **12 OR 115 VOLT OPERATED:**
Simply specify at time of order
- › **MANIFOLD INTEGRATION:**
On any manufacturers cascade system

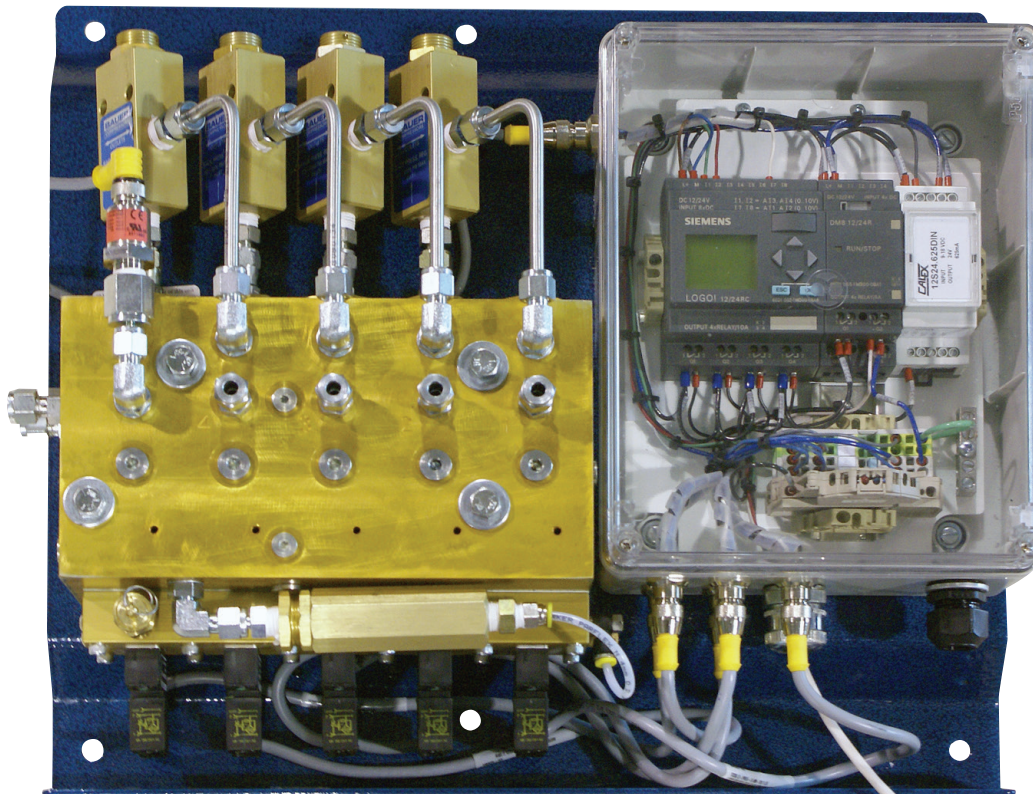

STANDARD SCOPE OF SUPPLY

- › Corrosion resistant high strength aluminum alloy manifold block
- › Programmable Logic Controller for simplistic operation and heightened accuracy
- › No adjustable shuttle valves
- › LED indication as to which cascade cylinder is being utilized
- › The system can be utilized on either stationary or mobile cascade systems
- › A preset pressure bias of 0 PSIG can be adjusted to allow for quicker switch over time from one bank to another
- › Pressure sensing by transducers rather than sequential valves, provides greater accuracy without leaks or pressure drift
- › A bypass circuit is incorporated into the system allowing the storage system to be bypassed. This enhancement allows for more effective hose reel operation or possibly filling a mobile cascade system from a stationary system
- › Can be installed onto any existing fill station or wall mounting

SAFETY AND ADDED VALUE

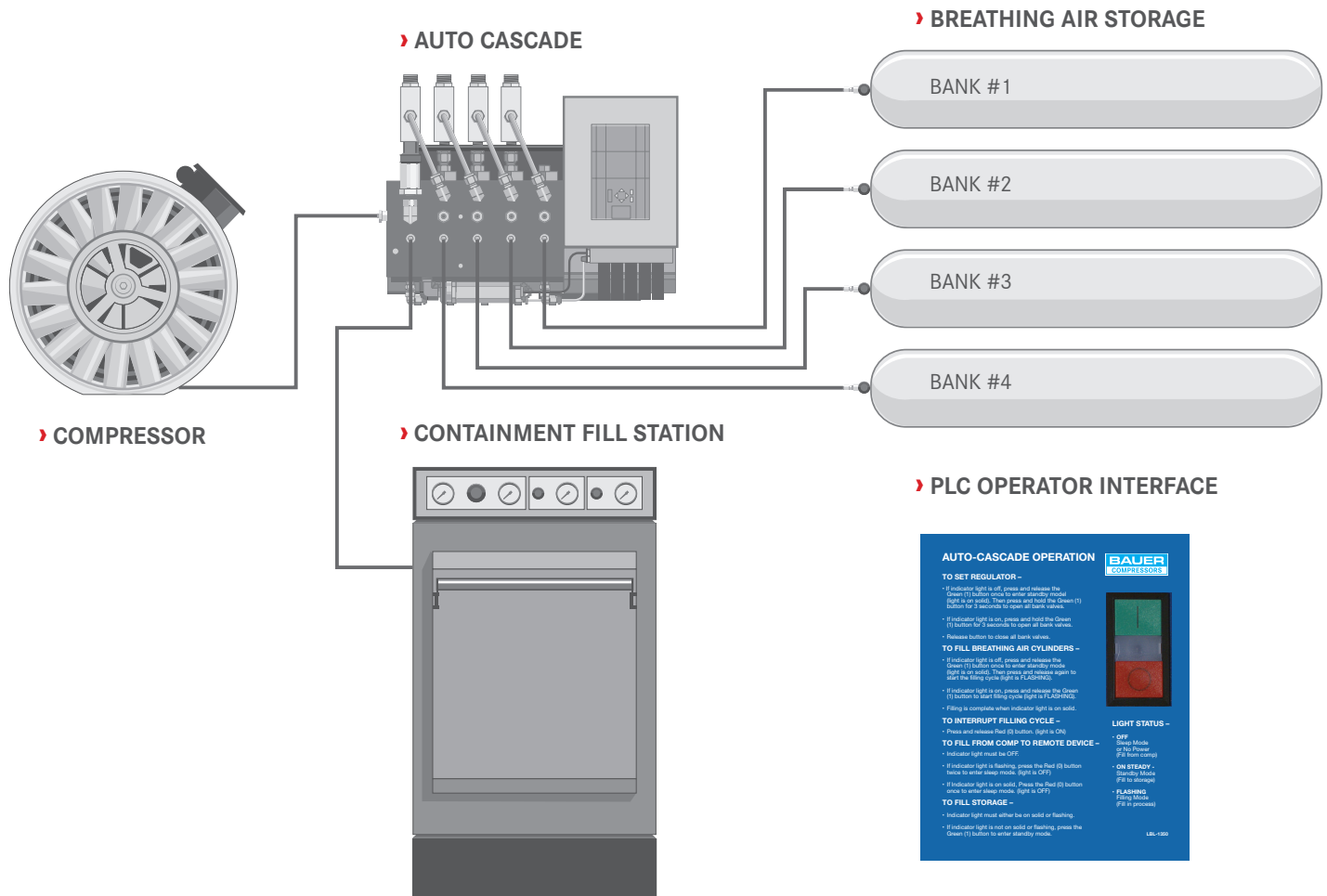

AUTO-CASCADE OPERATION

TO SET REGULATOR -

- If indicator light is off, press and release the Green (1) button twice to enter standby mode. Light is on solid. Then press and hold the Green (1) button for 3 seconds to open all bank valves.
- Release button to close all bank valves.

TO FILL BREATHING AIR CYLINDERS -

- If indicator light is off, press and release the Green (1) button twice to enter standby mode. Light is on solid. Then press and release again to start the filling pump (light is a flashing red).
- If indicator light is on, press and release the Green (1) button to start filling pump (light is flashing red).
- Filling is complete when indicator light is on solid.

TO INTERRUPT FILLING CYCLE -

- Press and release Red (3) button, light is ON.

TO FILL FROM COMP TO REMOTE DEVICE -

- Indicator light must be OFF.
- If indicator light is flashing, press the Red (3) button twice to enter sleep mode. Light is OFF.
- If indicator light is on solid, Press the Red (3) button twice to enter sleep mode. Light is OFF.

TO FILL STORAGE -

- Indicator light must either be on solid or flashing, press the Green (1) button to enter standby mode.

LIGHT STATUS -

OFF
Sleep Mode
No Air Pressure
(3) button normal

ON STEADY
Standby Mode
(1) in standby

FLASHING
Filling Mode
(1) in process

LB-100